

Fig 61 Goad map of 1870



Fig 62 Tie-backs to Georgian slipway in Area 4 / Trench 51, truncated to the east by later slipway No 5

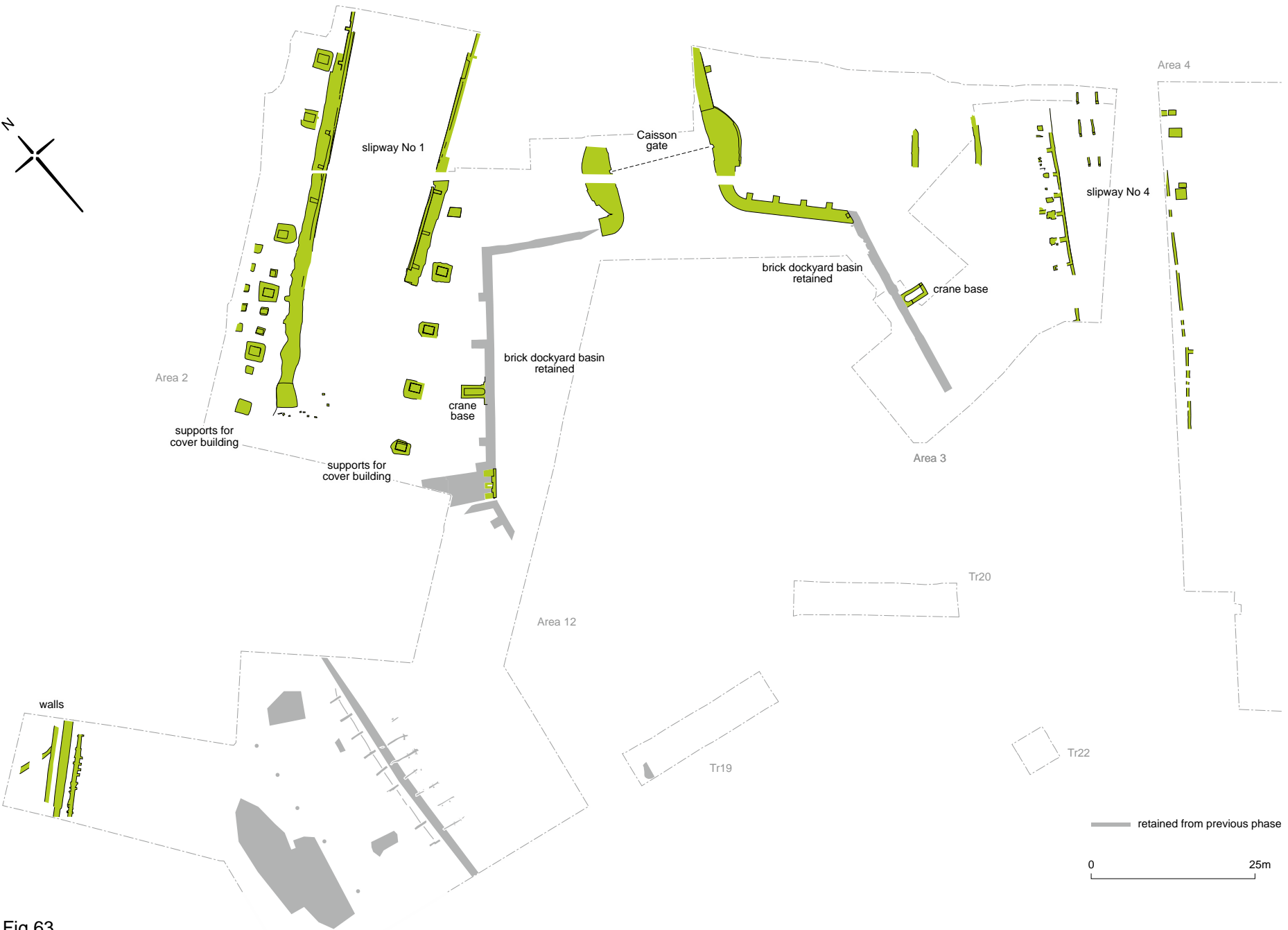

Fig 63
Site plan of late Georgian to Victorian structures (Areas 2, 3, 12, Trenches 9, 11, 19, 37)



Fig 64 No 1 slipway (Area 2), looking south



Fig 65 No 1 slipway (Area 2) and the northwest corner of Area 2, looking east



Fig 66 No 1 slipway (Area 2), looking north



Fig 67 No 5 slipway (Area 4), looking south

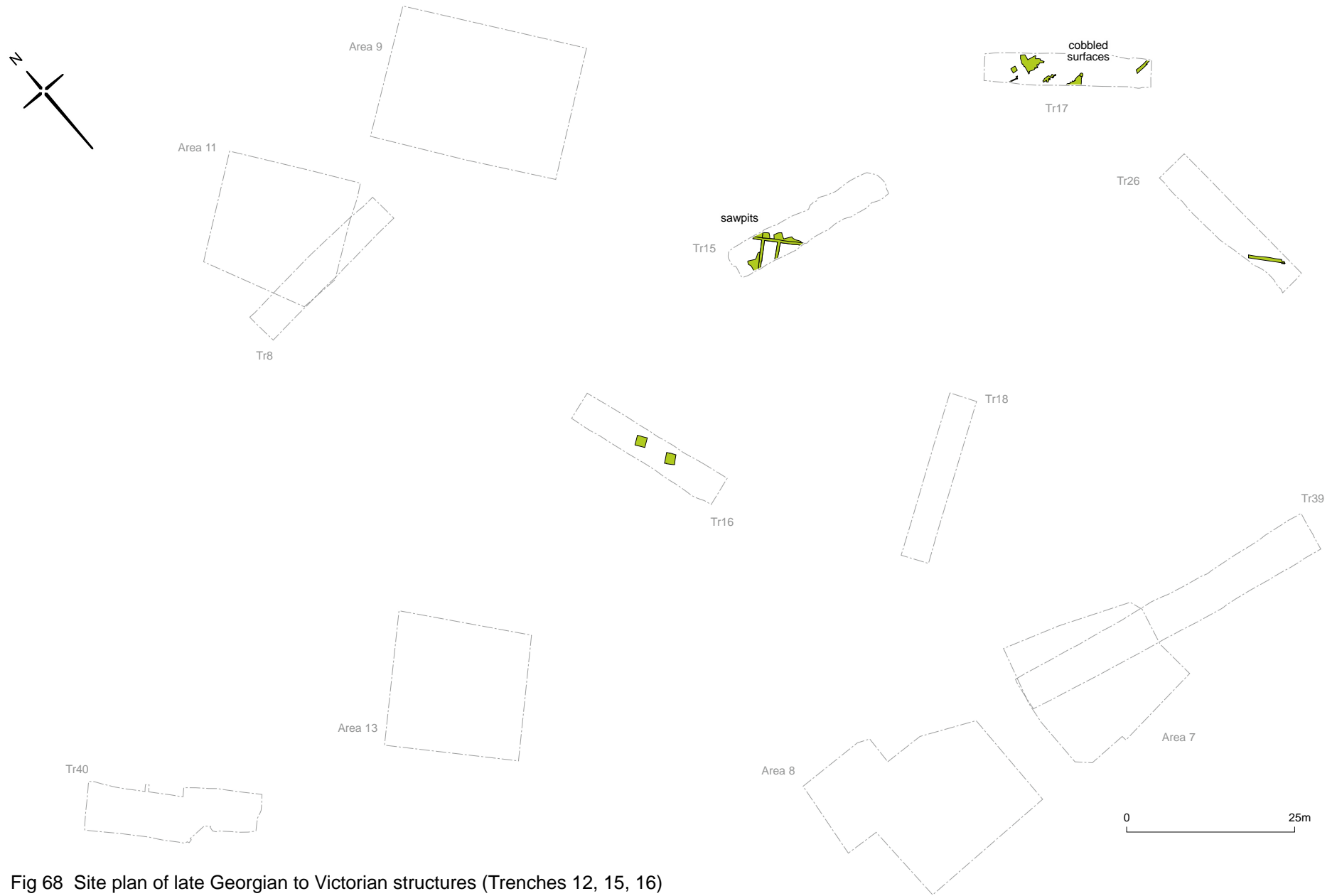

Fig 68 Site plan of late Georgian to Victorian structures (Trenches 12, 15, 16)

Fig 69
No 4 slipway (Area 3) with N-S
running baseplate, looking south



Fig 70 No 4 slipway (Area 3), looking south

Fig 71
Part of stone wall of slipway No 2
in Trench 21, looking west



Fig 72 Part of stone wall of slipway No 2 in Trench 23, looking west



Fig 73 Site plan of late Georgian to Victorian structures (Trenches 21, 22, 23, 24, 28)



Fig 74 Eastern part of the brick basin gate with depth gauge (in Roman numerals), in Area 2, looking east. Note superseded earlier timber gate in background



Fig 75 John Rennie's brick basin gate in Area 2, looking east



Fig 76 Stone shaft in Rennie's gate in Area 2

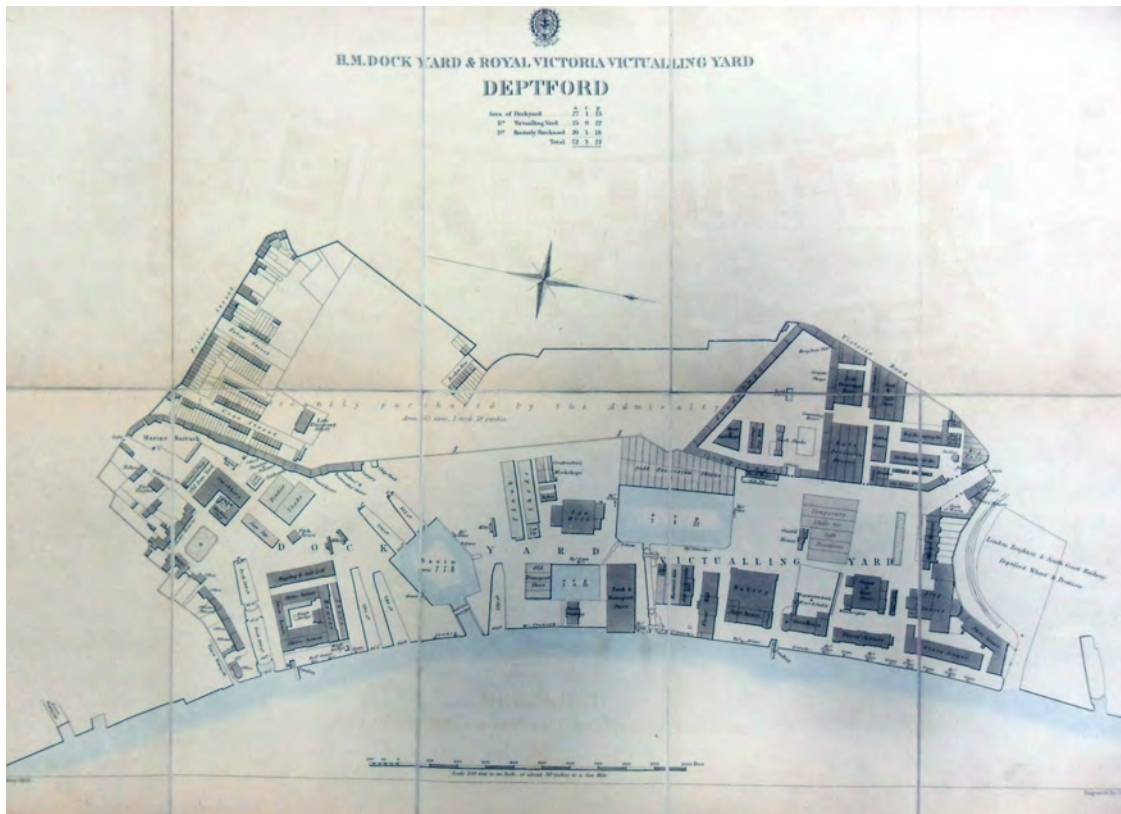

Fig 77 1858 map



Fig 78 Brick structure (top of image) in Trench 25, looking west. Later culvert in foreground



Fig 79 Western part of Area 12 brick walls and culvert, looking south

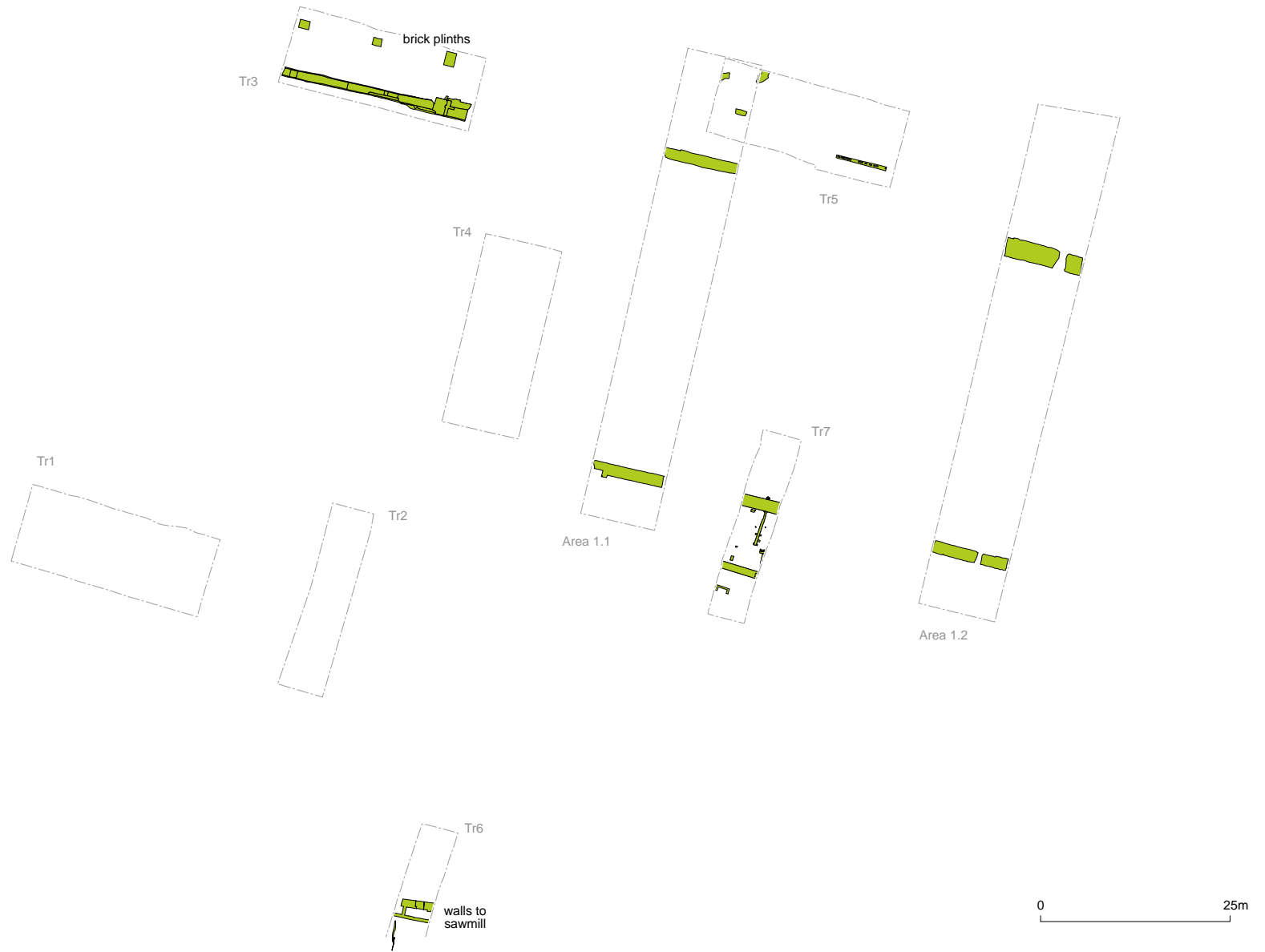
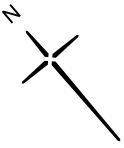

Fig 80 Site plan of late Georgian to Victorian structures (Areas 1.1, 1.2, Trenches 3, 5, 6)



Fig 81 South wall of Small Mast Pond and associated tie-back in Trench 7, looking north



Fig 82 Timber baseplate in Trench 5, looking northwest



Fig 83 The Great Mast Pond north wall in Trench 1, looking north



Fig 84 Capstan base in Trench 1, looking south



Fig 85 Opening for canal, linking Great Mast Pond and Small Mast Pond, Trench 1, looking north



Fig 86 Site plan of late Georgian to Victorian structures (Areas 5.1 and 5.2, Trenches 42, 43, 45)



Fig 87 West wall of the Great Dock in Trench 50, looking northwest. Iron and timber dock gate to right



Fig 88 West wall of the Great Dock in Trench 50, looking northwest. Iron and timber dock gate to right



Fig 89 East wall of the Great Dock in Trench 50, looking southeast. Painted depth gauge on left



Fig 90 Photograph of c 1880 showing cover building to Great Dock (left) and rigging and sail loft building with storehouse behind



Fig 91 Brick sawpit in Trench 15, looking east



Fig 92 Remains of steam kiln building (centre) with surviving abutting cobbled yard in Trench 10, looking southeast

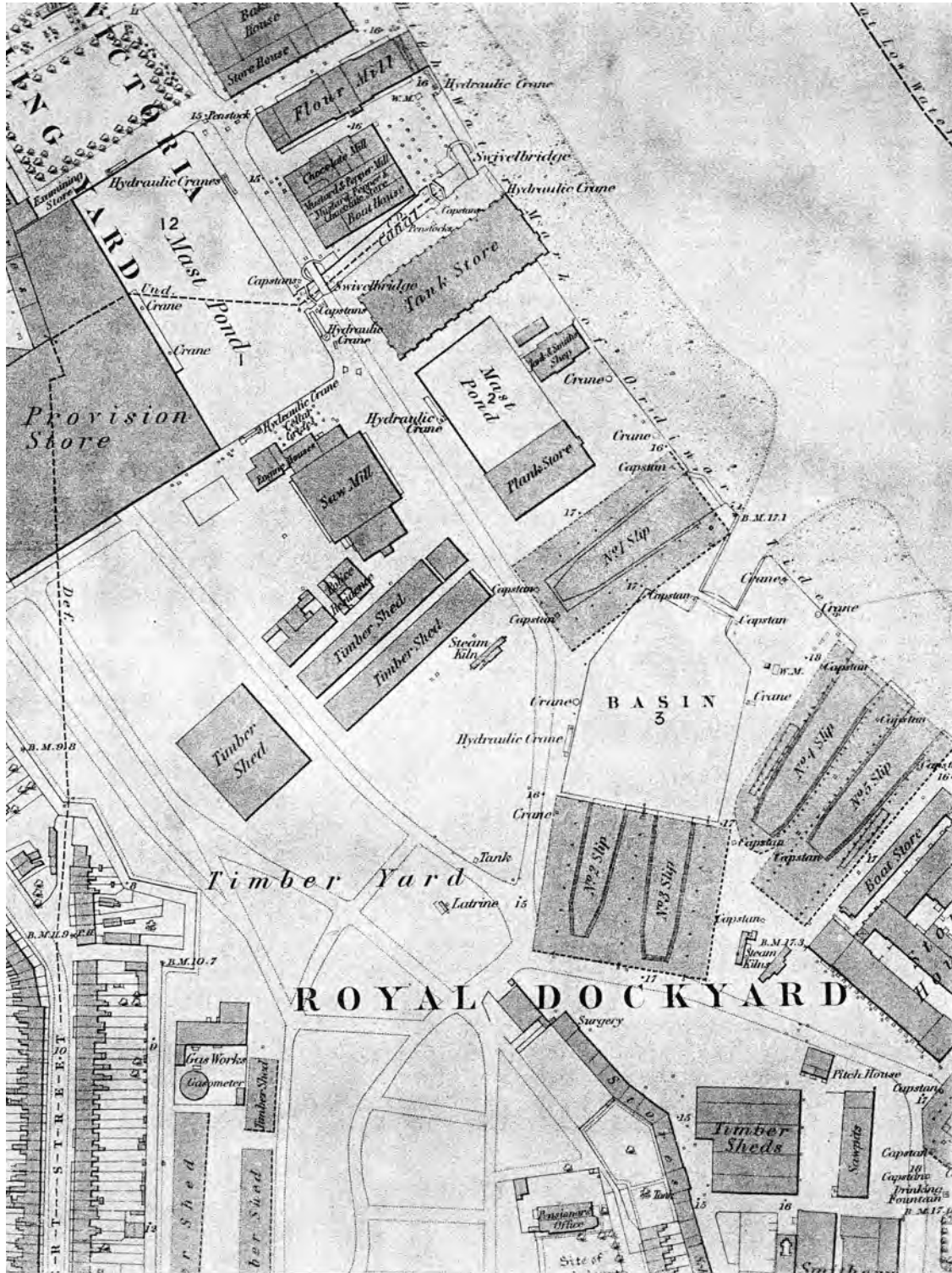
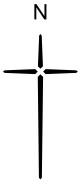

Fig 93 1868 OS map of Dockyard 1:2500 (not to scale)



Fig 94 Cobbled surface in Trench 17, looking northwest



Fig 95 Timber platform in Trench 16, looking south



Fig 97 Site plan of post-Dockyard structures (Area 4)

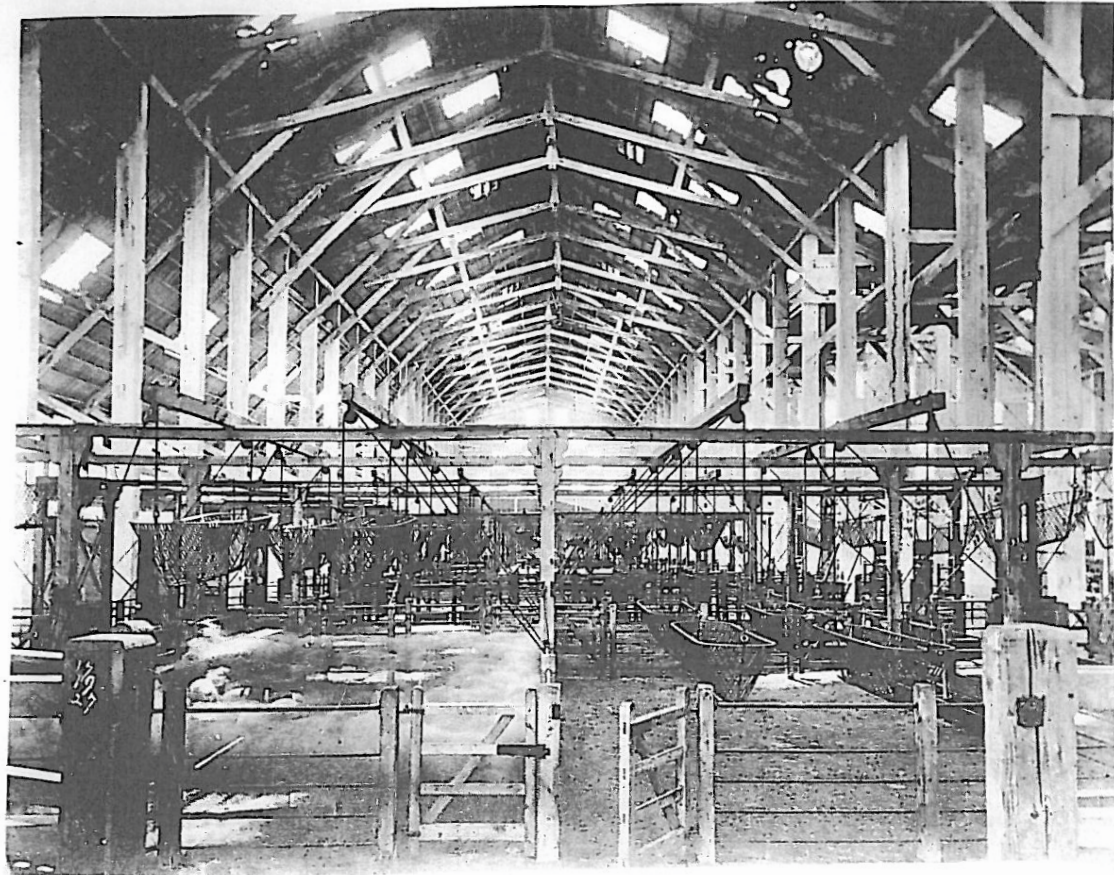

Fig 98 Cover building to No 4 slipway (Area 3/4) converted to a 'sheep shed' after 1869 closure of Dockyard

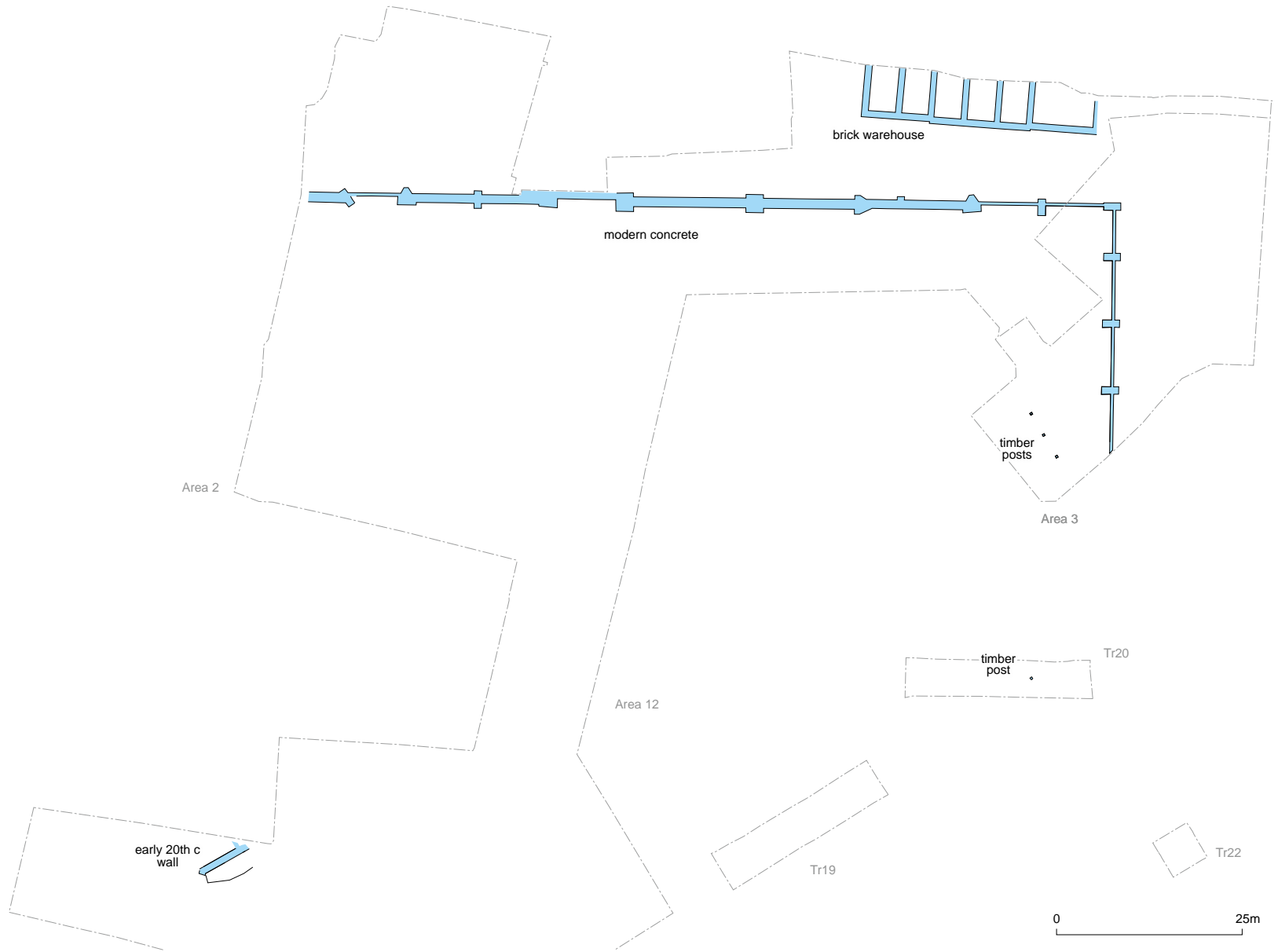
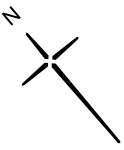

Fig 99 Site plan of post-Dockyard structures (Areas 2, 3 and 12, Trenches 9, 20)

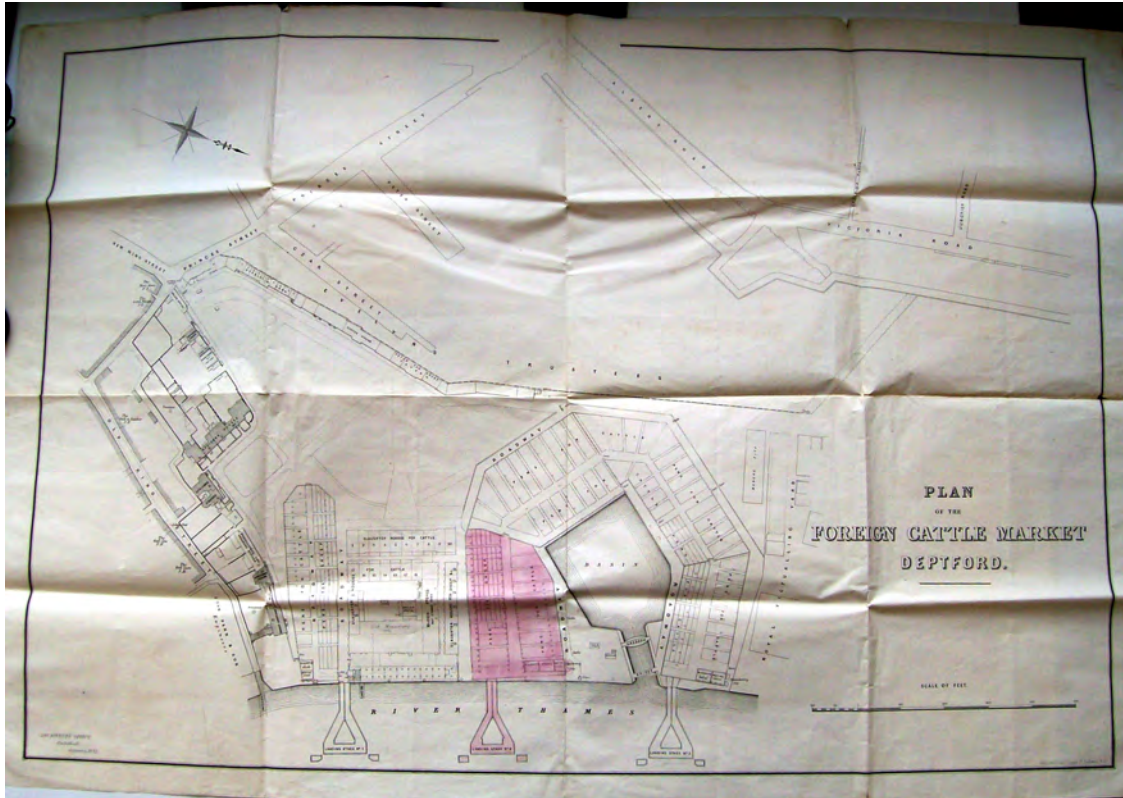

Fig 100 Map of 1872



Fig 101 Site plan of post-Dockyard structures (Trenches 25, 27, 28)



Fig 102 Site plan of post-Dockyard structures (Areas 9, 11, Trenches 15, 16, 26, 39, 40)



Fig 103 18th century building converted to a cold store in Area 4, looking west

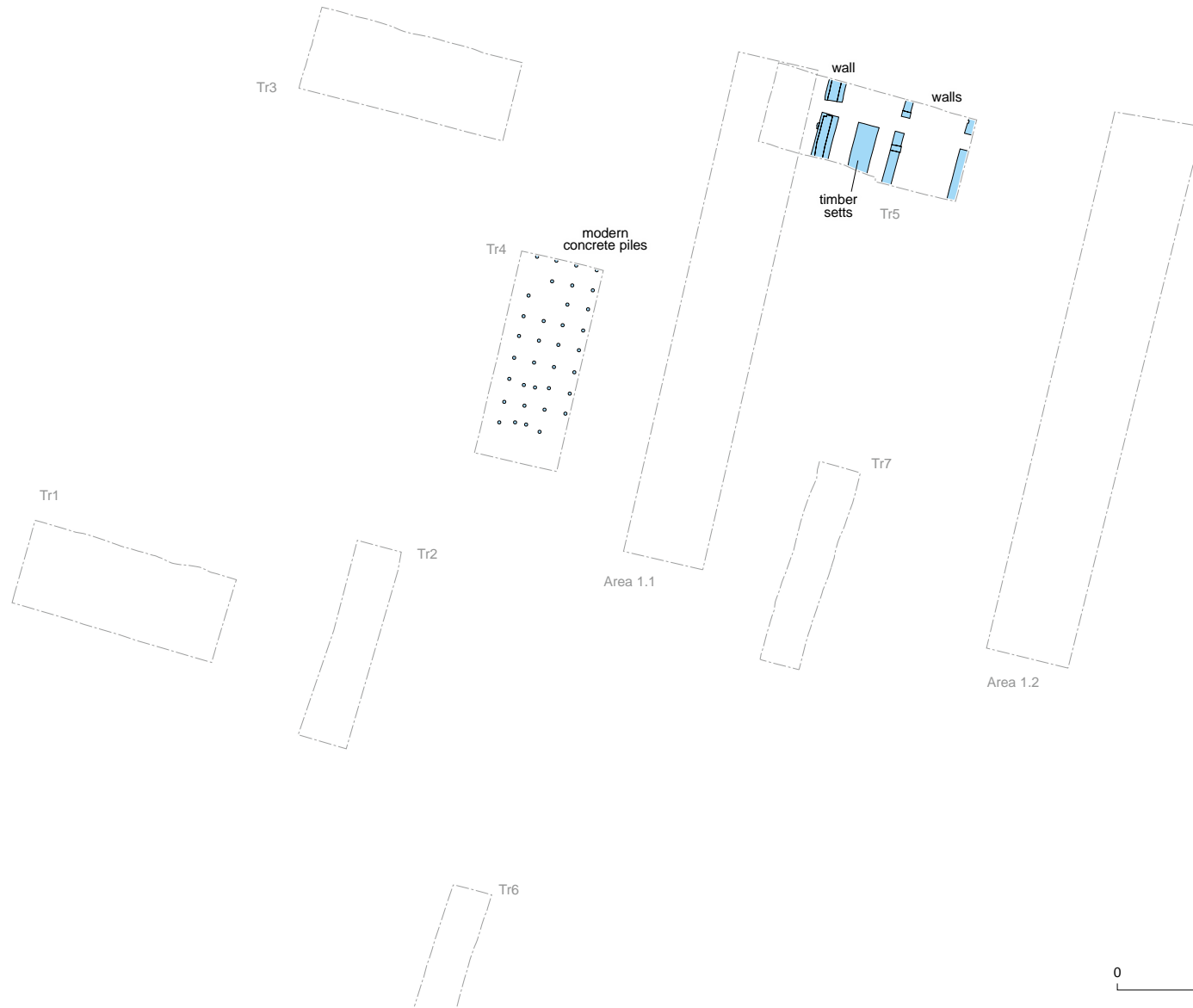
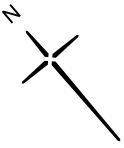

Fig 104 Site plan of post-Dockyard structures (Trenches 4, 5)

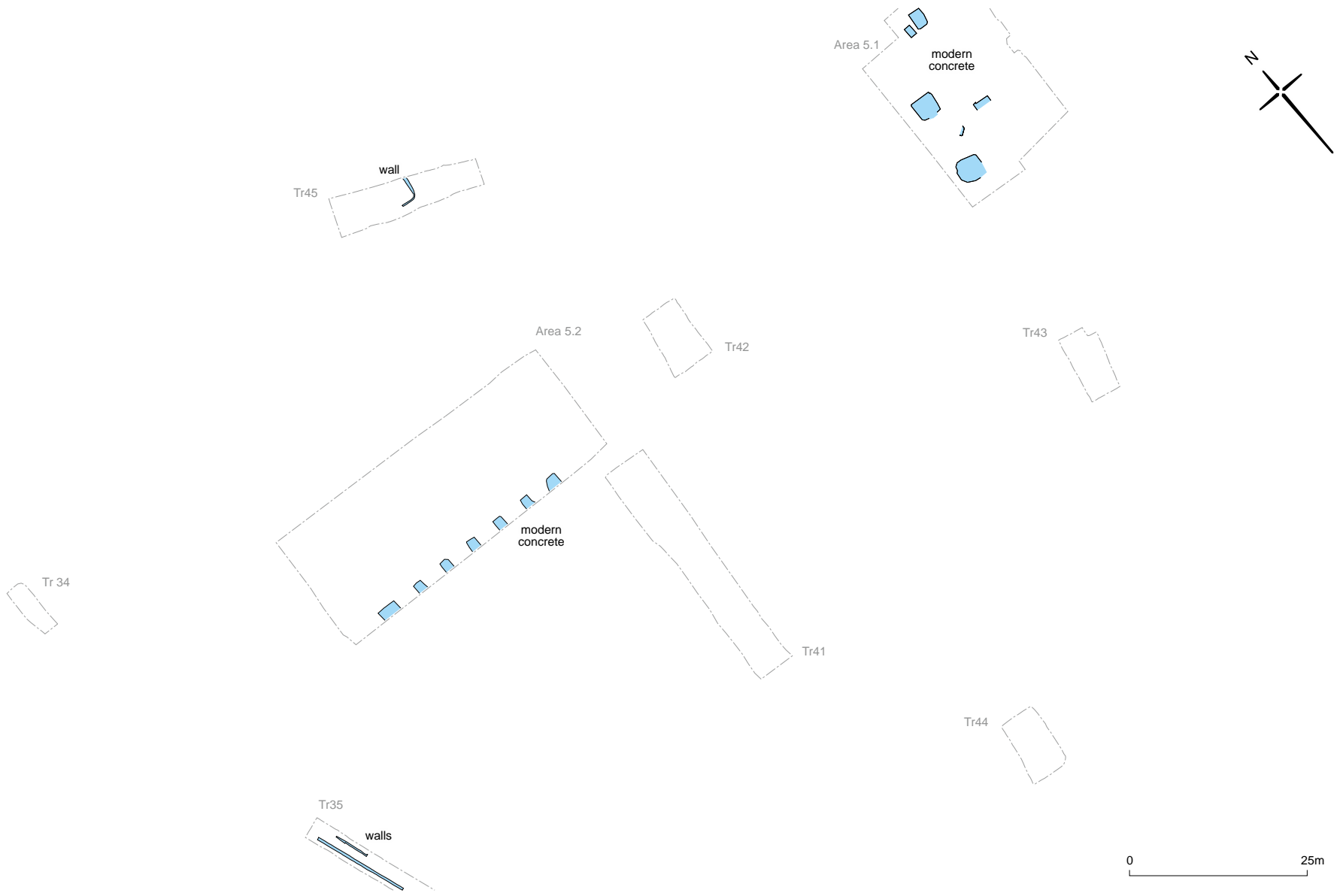

Fig 105 Site plan of post-Dockyard structures (Areas 5.1 and 5.2)

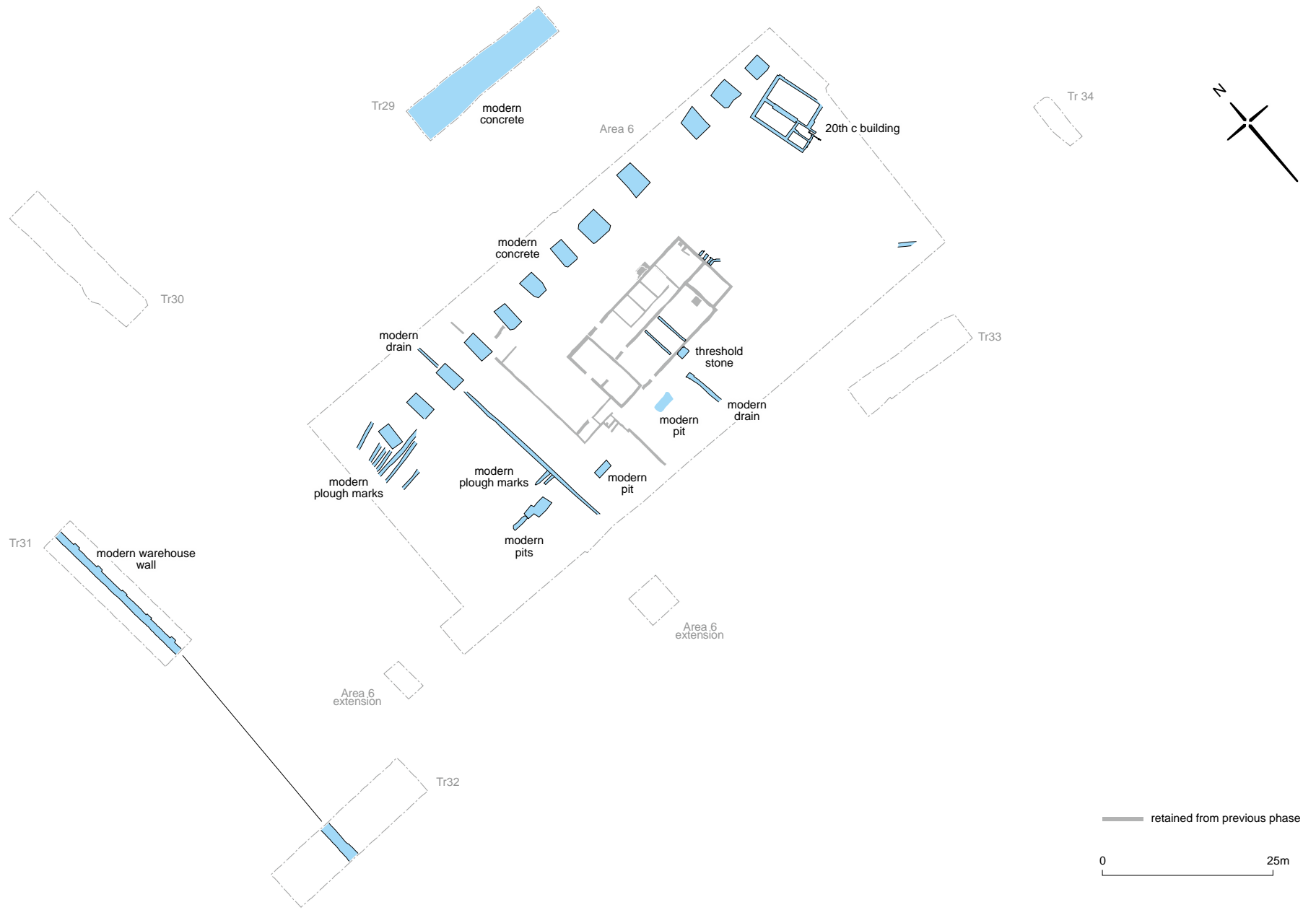
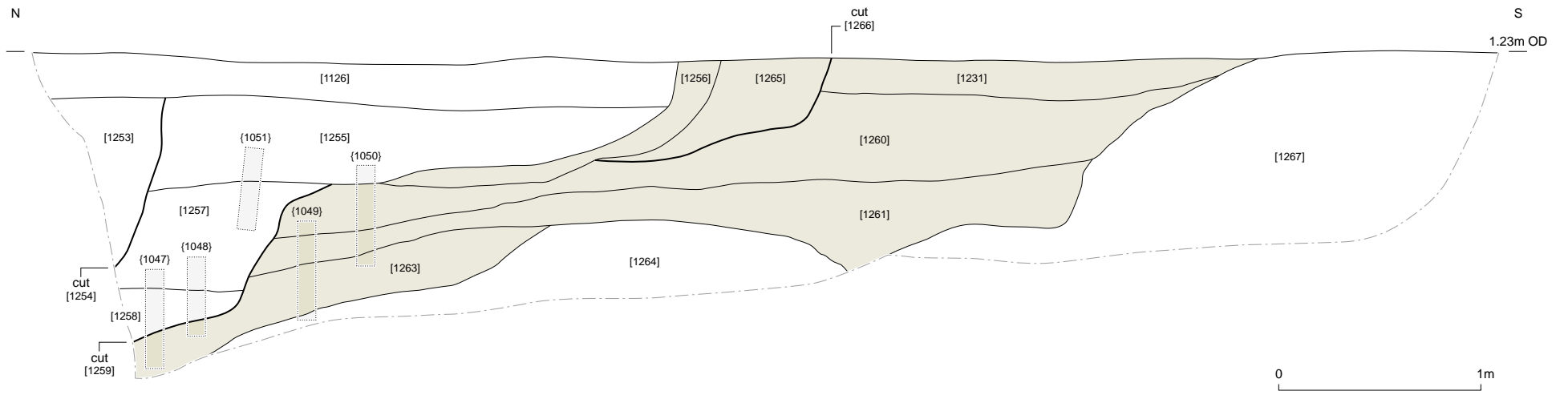

Fig 106 Site plan of post-Dockyard structures (Area 6)



Fig 107 Areas 11 and 9 (in background), looking northeast



LEW1047PXA13#108

CVF10 post-excavation assessment © MOLA 2013

Fig 108 Area 8 section 12

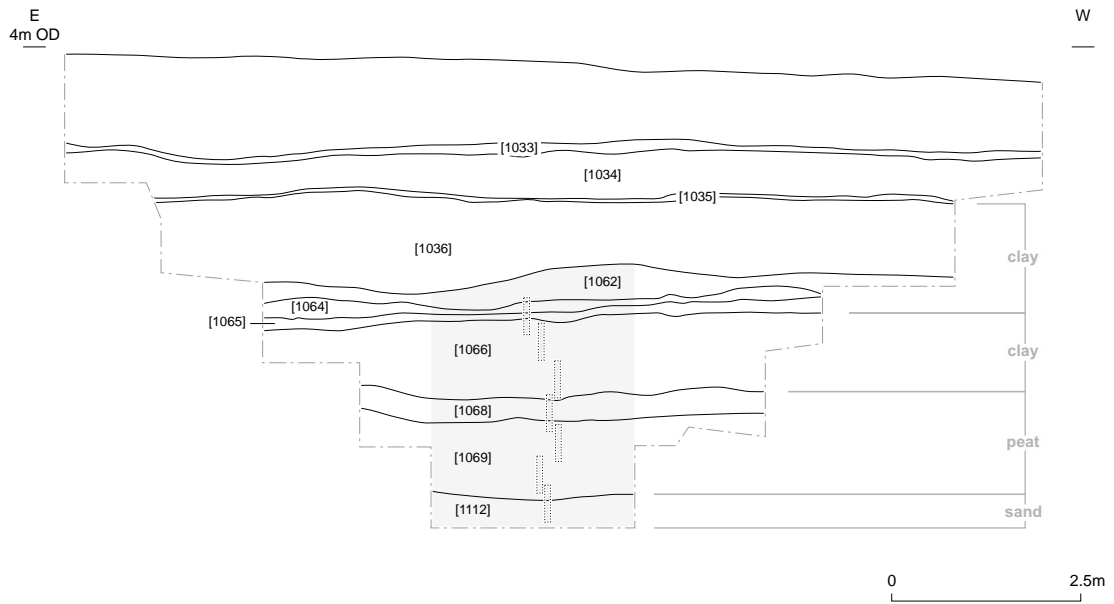

Fig 109 Area 10 section 1

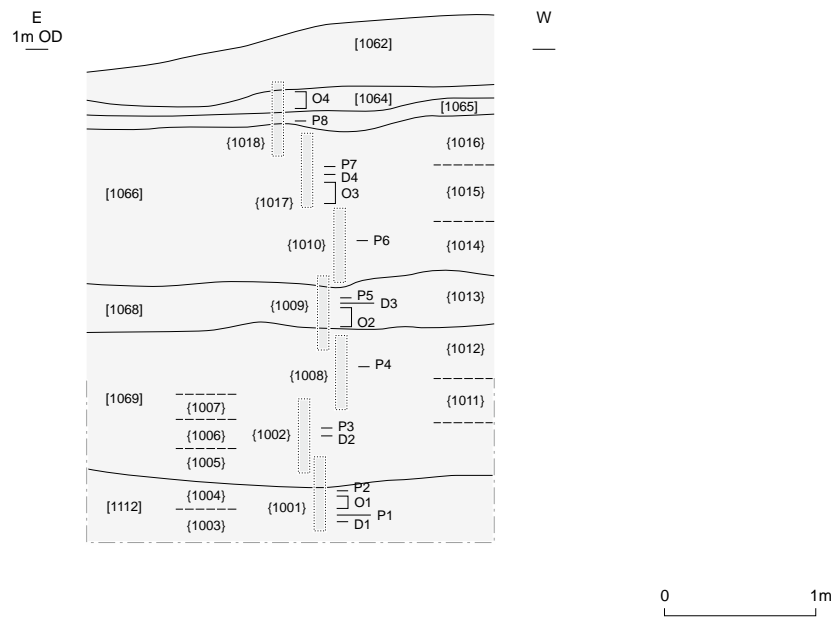
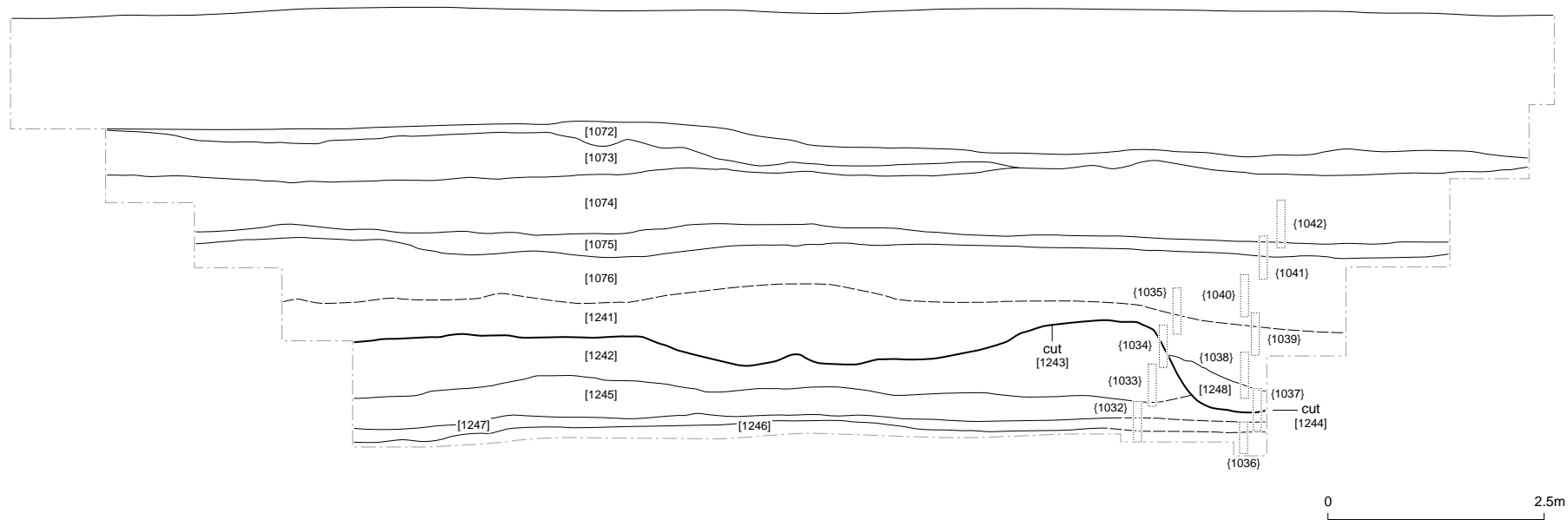

Fig 110 Subsample locations in area 10

E
4m OD

W



LEM1047XA13#111

CVF10 post-excavation assessment © MOLA 2013

Fig 111 Area 13 section 9

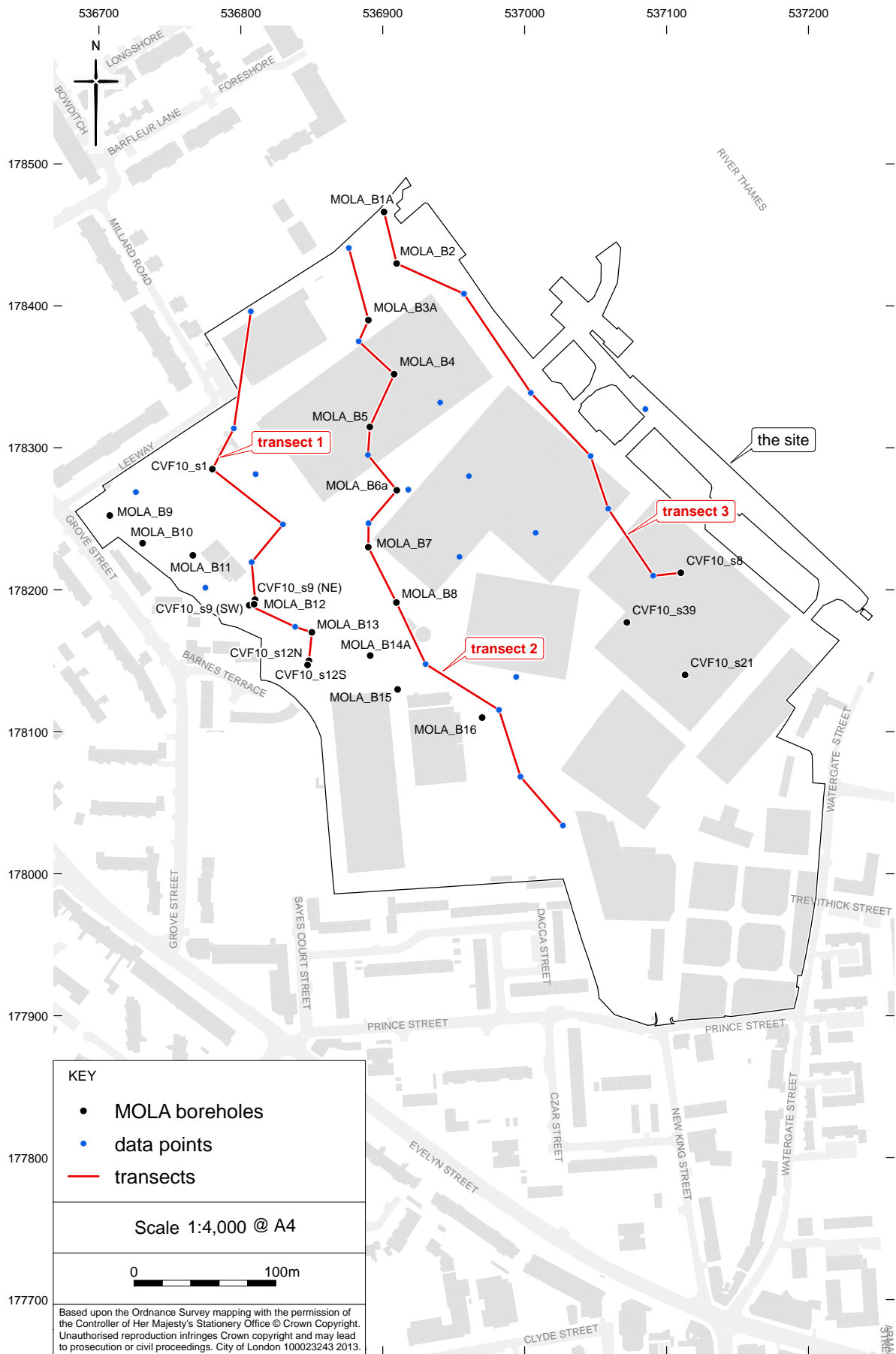
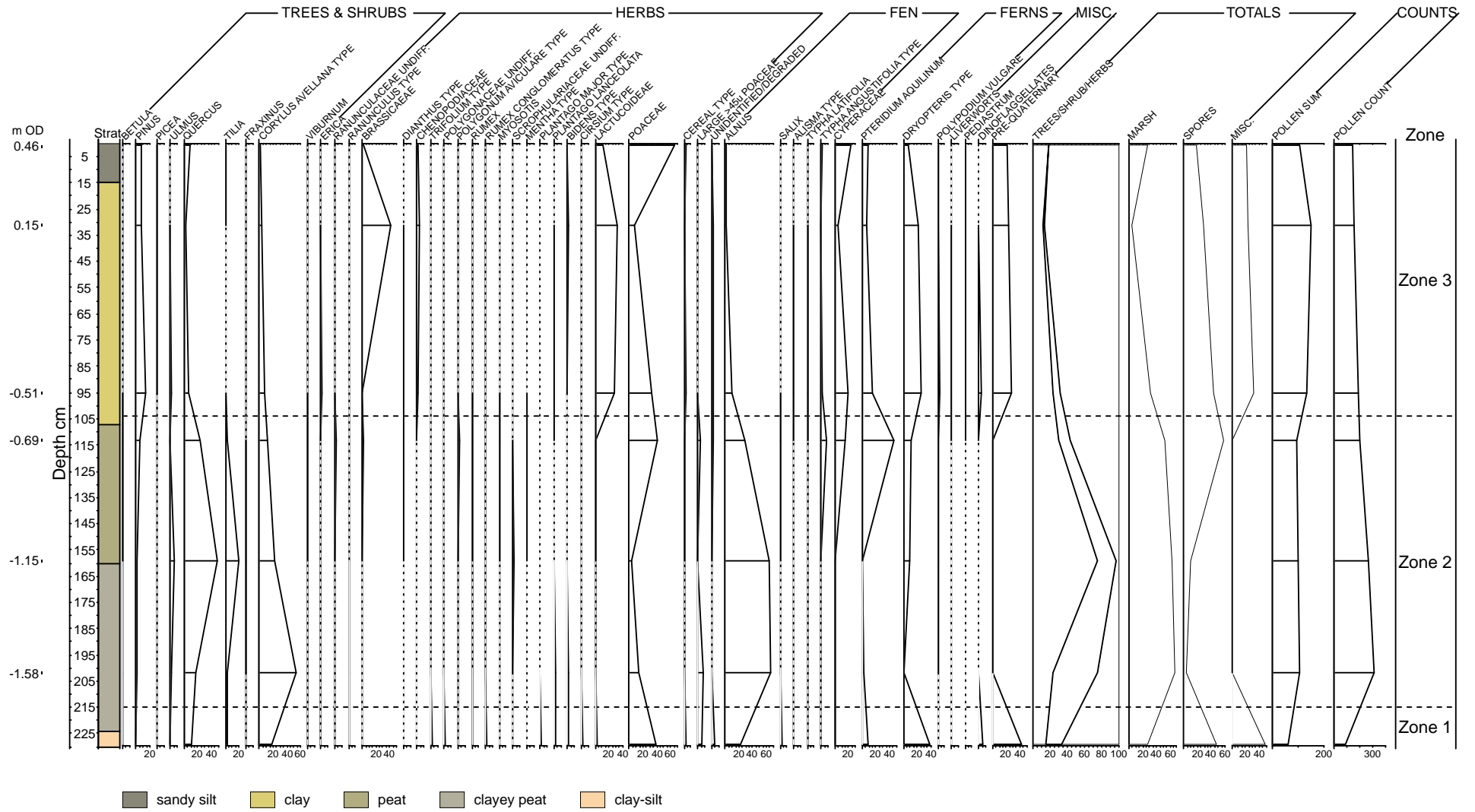

Fig 112 Data point and transect locations

LEW1047PX13#113



CVF10 post-excavation assessment © MOLA 2013

Fig 113 Pollen diagram

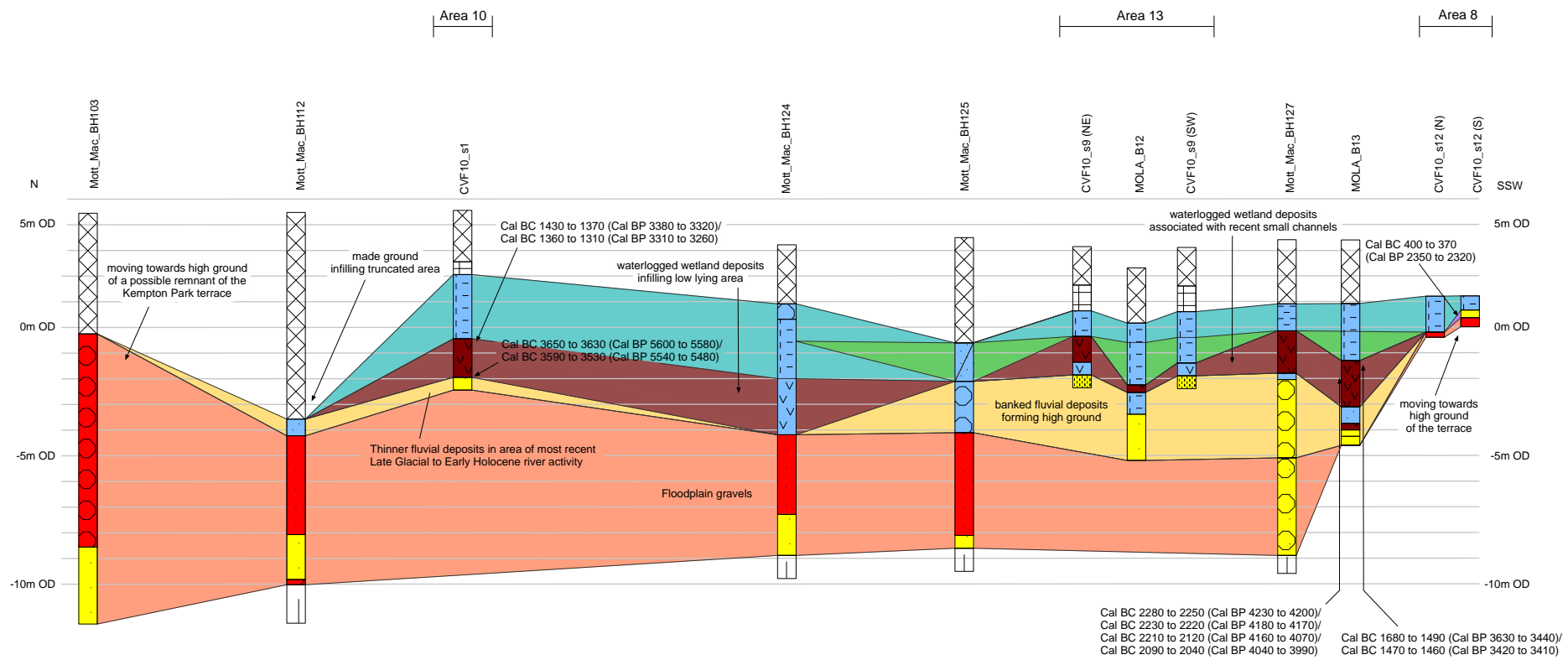

Lithology

- madeground
- madeground, alluvium
- chalk
- clay
- clay with organics
- peat
- clay, gravelly
- silty clay
- clay, sandy
- sand, silty
- sand, gravelly
- gravel, clayey
- gravel, sandy

Stratigraphy

- Pleistocene gravel (facies 1)
- Late glacial to Early Holocene fluvial sands (facies 2)
- wetland deposits (facies 3)
- colluvial deposits (facies 4)
- Late prehistoric to historic channel/scour (facies 5)
- alluvium (facies 6)
- made ground (facies 7)

LEW1047PX13#114

CVF10 post-excavation assessment © MOLA 2013

Fig 114 Western north to south Transect 1

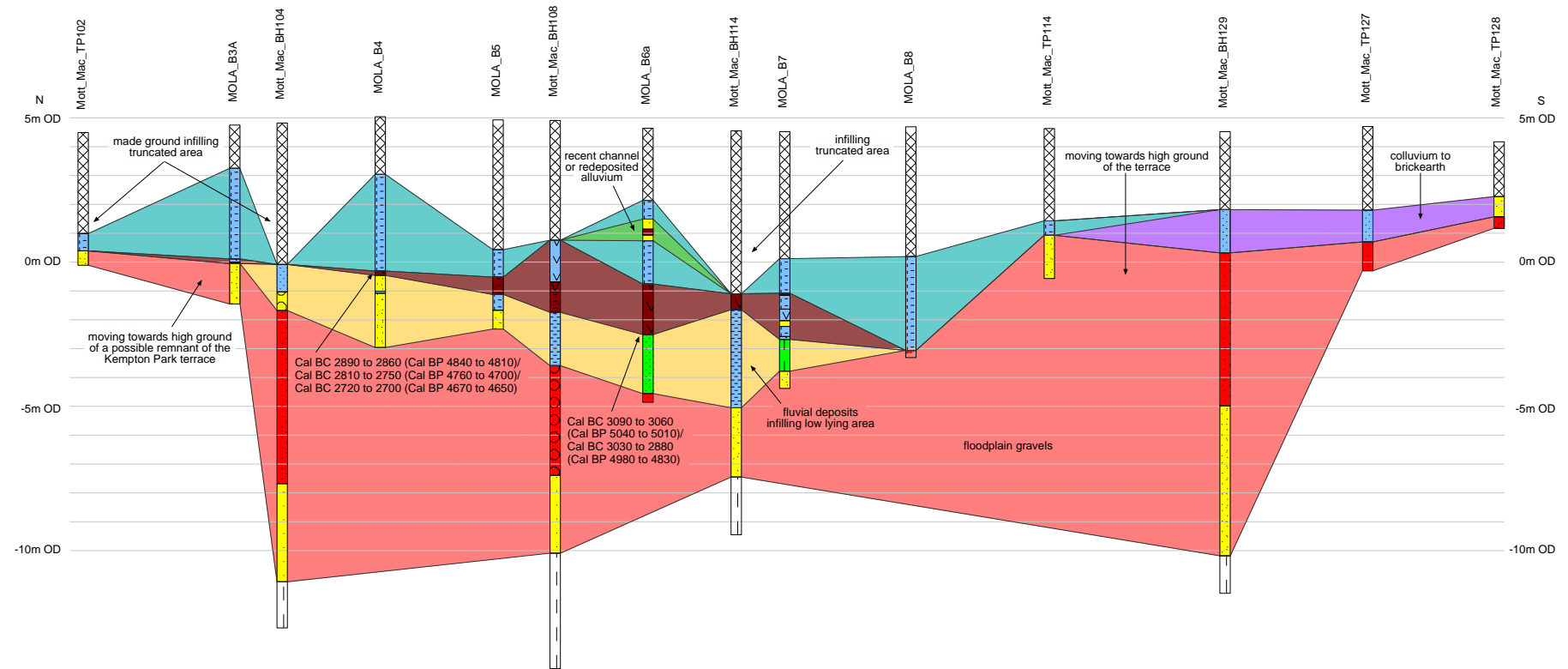

Lithology

- | | | | |
|--------------|--------------------|-------------|----------------|
| madeground | clay | clay, sandy | sand |
| peat | clay with organics | silty clay | sand, gravelly |
| peat, clayey | silty clay | clay, sandy | gravel, clayey |
| | | | chalk |

Stratigraphy

- | | |
|---|---|
| Pleistocene gravel (facies 1) | Late prehistoric to historic channel/scour (facies 5) |
| Late glacial to Early Holocene fluvial sands (facies 2) | alluvium (facies 6) |
| wetland deposits (facies 3) | made ground (facies 7) |
| colluvial deposits (facies 4) | |

LEW1047PX13#115

CVF10 post-excavation assessment © MOLA 2013

Fig 115 Central north to south Transect 2

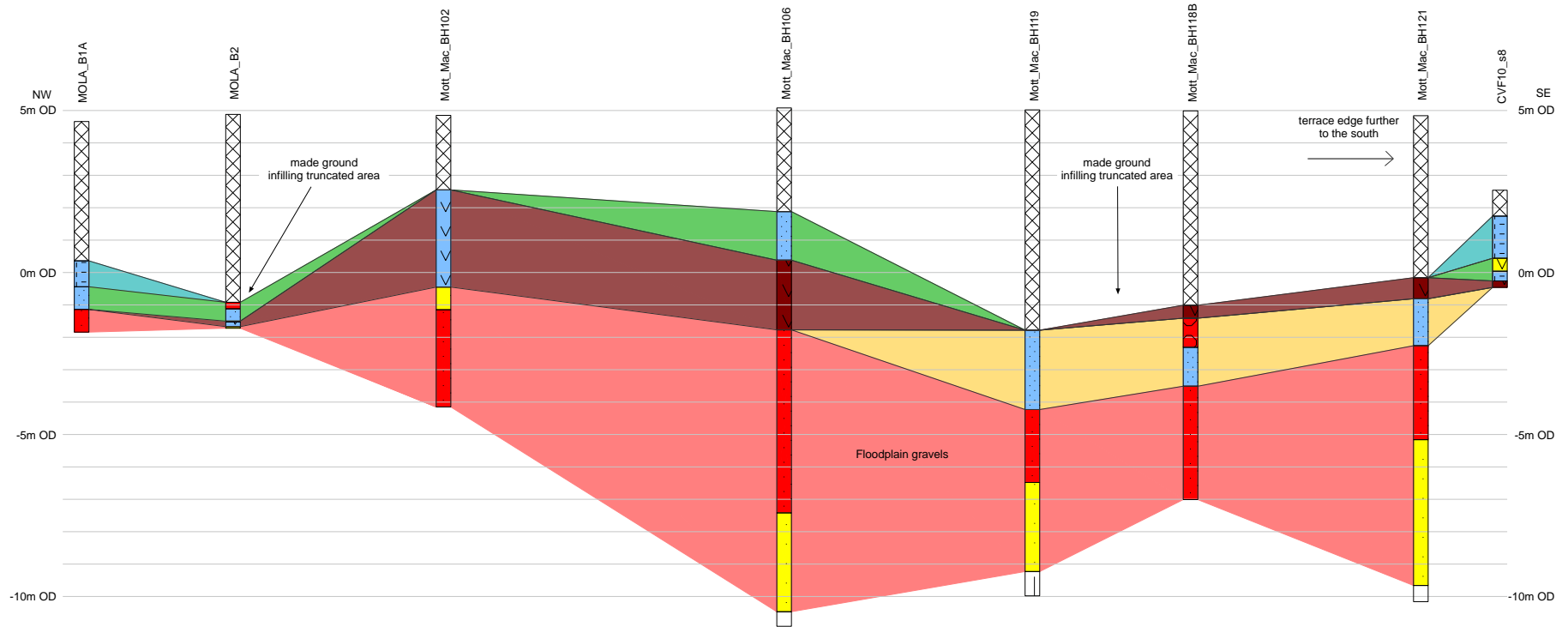

Lithology

- madeground
- clay, sandy
- sand
- gravel, sandy
- peat
- silty clay
- sand, gravelly
- chalk
- clay with organics
- sand, peaty
- gravel, clayey

Stratigraphy

- Pleistocene gravel (facies 1)
- Late glacial to Early Holocene fluvial sands (facies 2)
- Wetland deposits (facies 3)
- Late prehistoric to historic channel/scour (facies 5)
- alluvium (facies 6)
- madeground (facies 7)

LEW1047PX13#116

Fig 116 Eastern north to south Transect 3

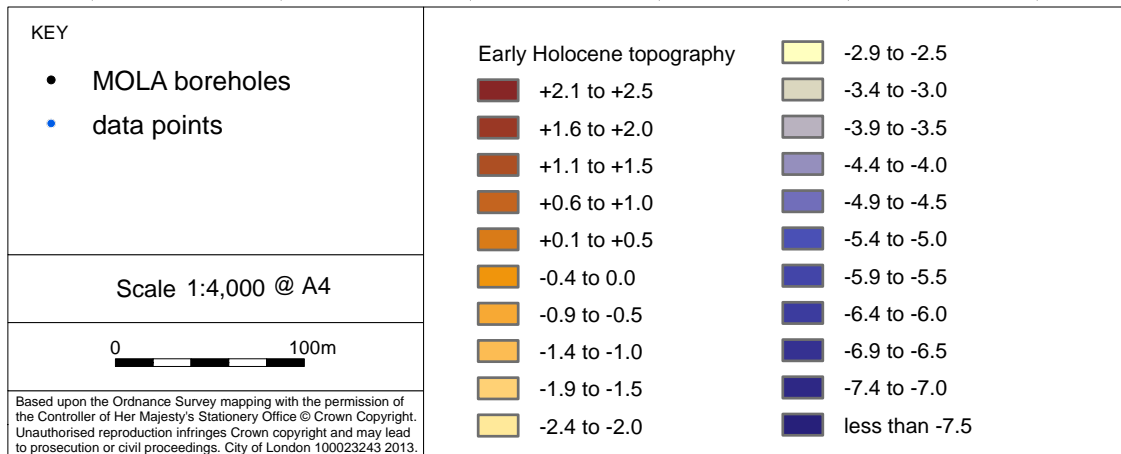
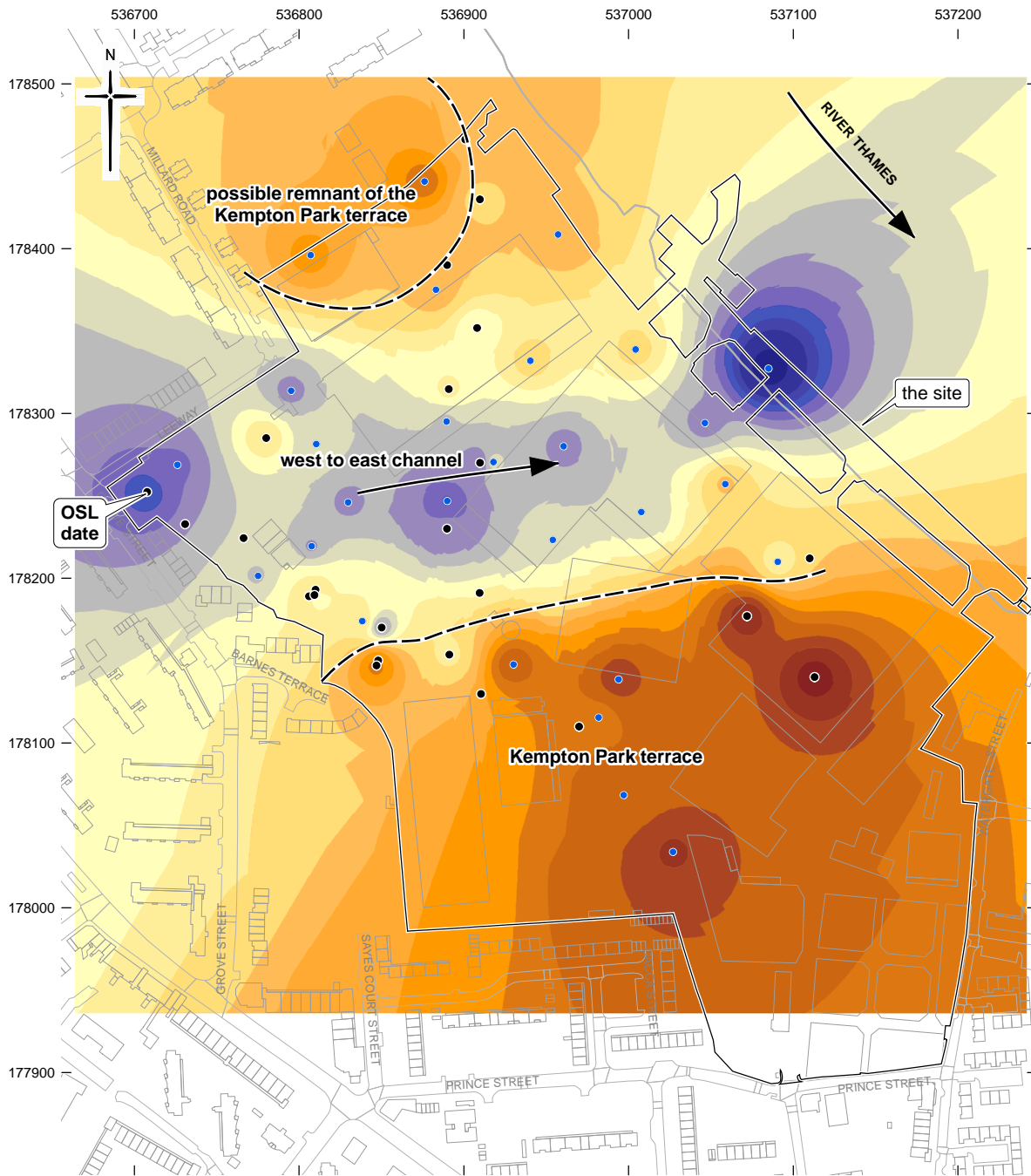

Fig 117 Early Holocene Topography



Fig 118 Area 2 stern post reused in crane, looking north